

- Key:**
- Carriageway surfacing
  - Footway surfacing
  - Bus stop treatment
  - Layby improvements
  - Tactile Paving

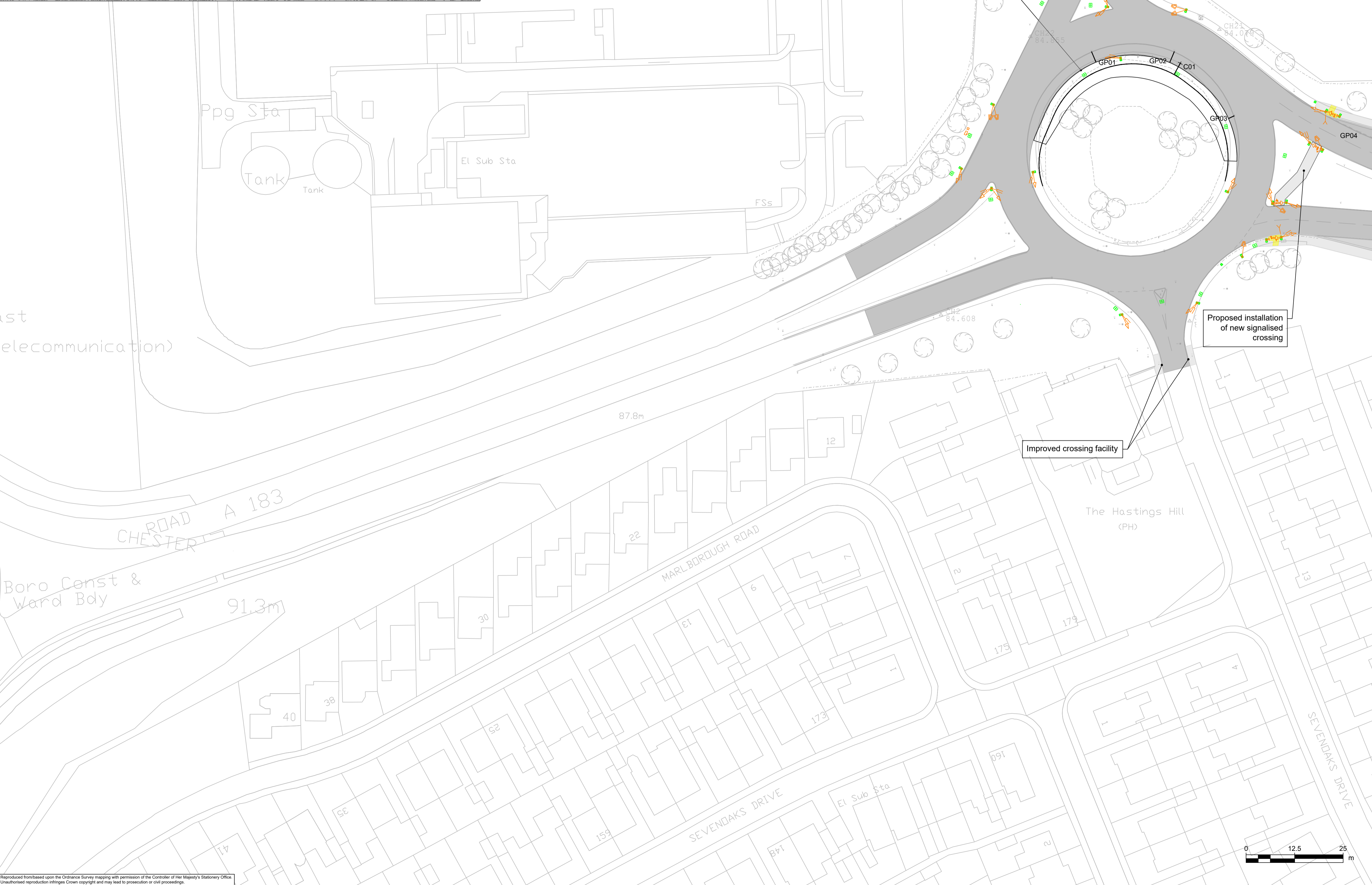

**FOR DISCUSSION**

P02	25.08.28	Addition of pedestrian crossing improvements and extent of improved surfacing	JT	PK
Rev.	Date	Description	Drawn	Approved

**Sunderland City Council**

**City Development Directorate**  
 City Hall,  
 Plater Way,  
 Sunderland,  
 SR1 3AA

Project  
**Bus Service Improvement Plan (BSIP) Chester Road**

Subject  
**Improvements (LTN124) Sheet 1 of 6**

Contact Peter Kennedy Approved by PK  
 Drawn by JS Sheet size A1  
 Scale 1:500 Date 13/06/2025

Drawing No. BSIPCR-SCC-HGN-00-DR-CR-01\_101 Revisions P02

Reproduced from/based upon the Ordnance Survey mapping with permission of the Controller of Her Majesty's Stationery Office. Unauthorised reproduction infringes Crown copyright and may lead to prosecution or civil proceedings. © Crown copyright and database rights 2024. Ordnance Survey Ltd. 100043361

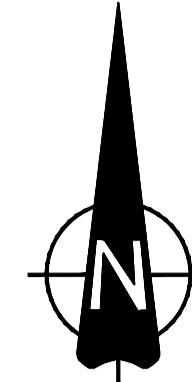
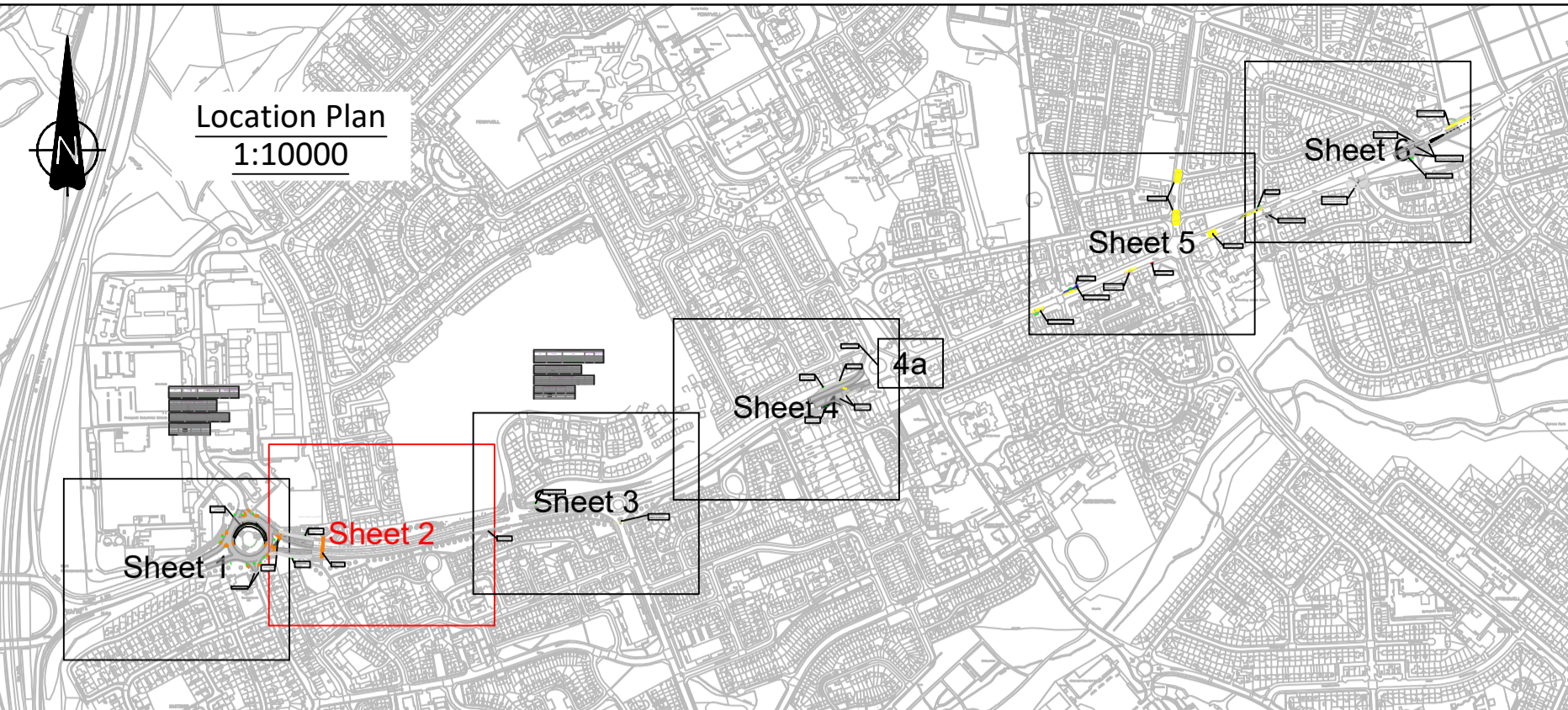

- Key:**
- Carriageway surfacing
  - Footway surfacing
  - Bus stop treatment
  - Layby improvements
  - Tactile Paving

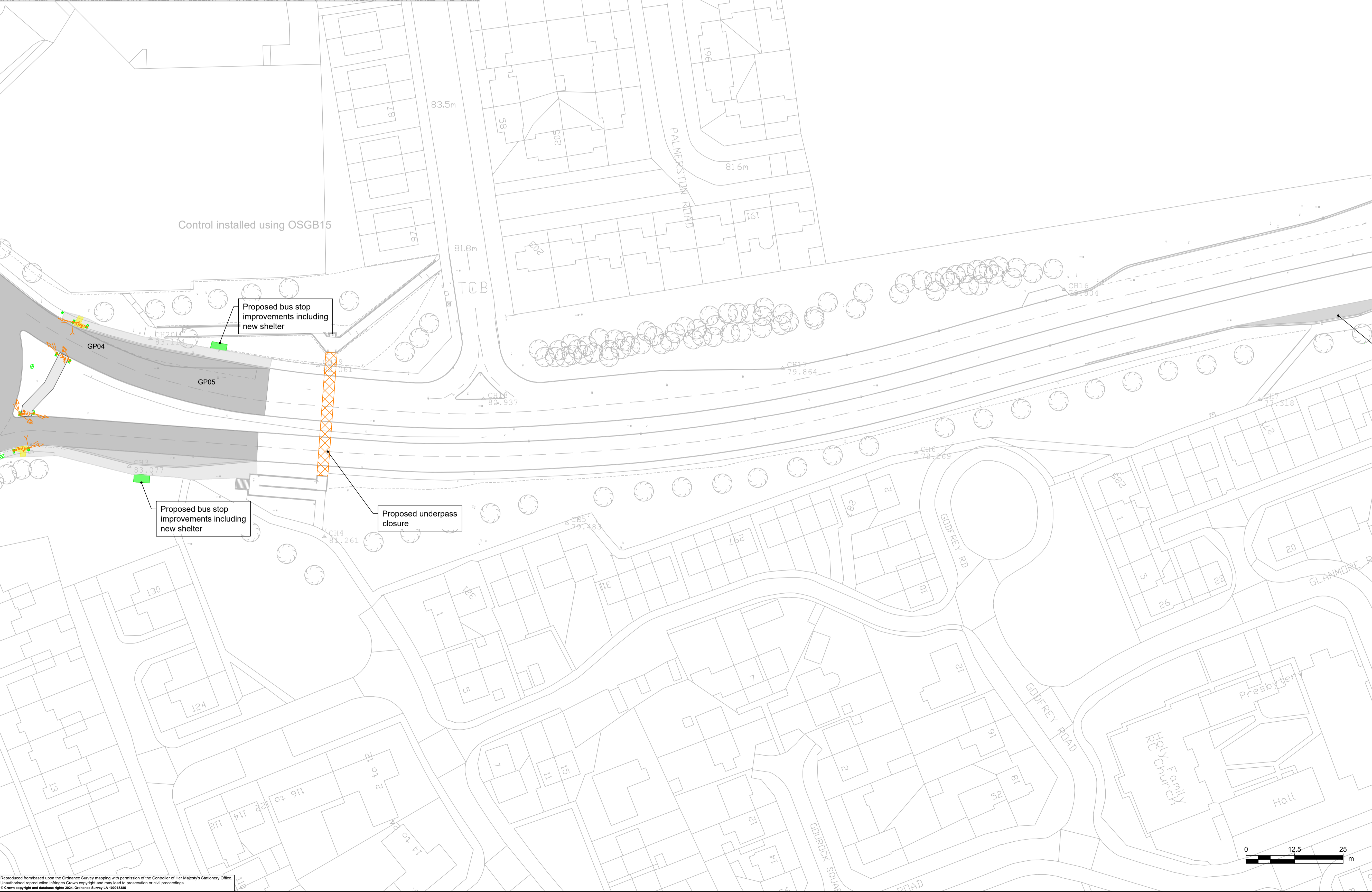

**FOR DISCUSSION**

Rev	Date	Description	Drawn	Approved
P02	25.08.28	Addition of pedestrian crossing improvements and extent of improved surfacing	JT	PK

**Sunderland City Council**

City Development Directorate  
 City Hall,  
 Plater Way,  
 Sunderland,  
 SR1 3AA

Project  
**Bus Service Improvement Plan (BSIP) Chester Road**

Subject  
**Improvements (LTN124) Sheet 2 of 6**

Contact Peter Kennedy Approved by PK  
 Drawn by JS Sheet size A1  
 Scale 1:500 Date 13/06/2025

Drawing No. BSIPCR-SCC-HGN-00-DR-CR-01\_102 Revisions P02

Reproduced from/based upon the Ordnance Survey mapping with permission of the Controller of Her Majesty's Stationery Office. Unauthorised reproduction infringes Crown copyright and may lead to prosecution or civil proceedings. © Crown copyright and database right 2024. Ordnance Survey 14 10004388



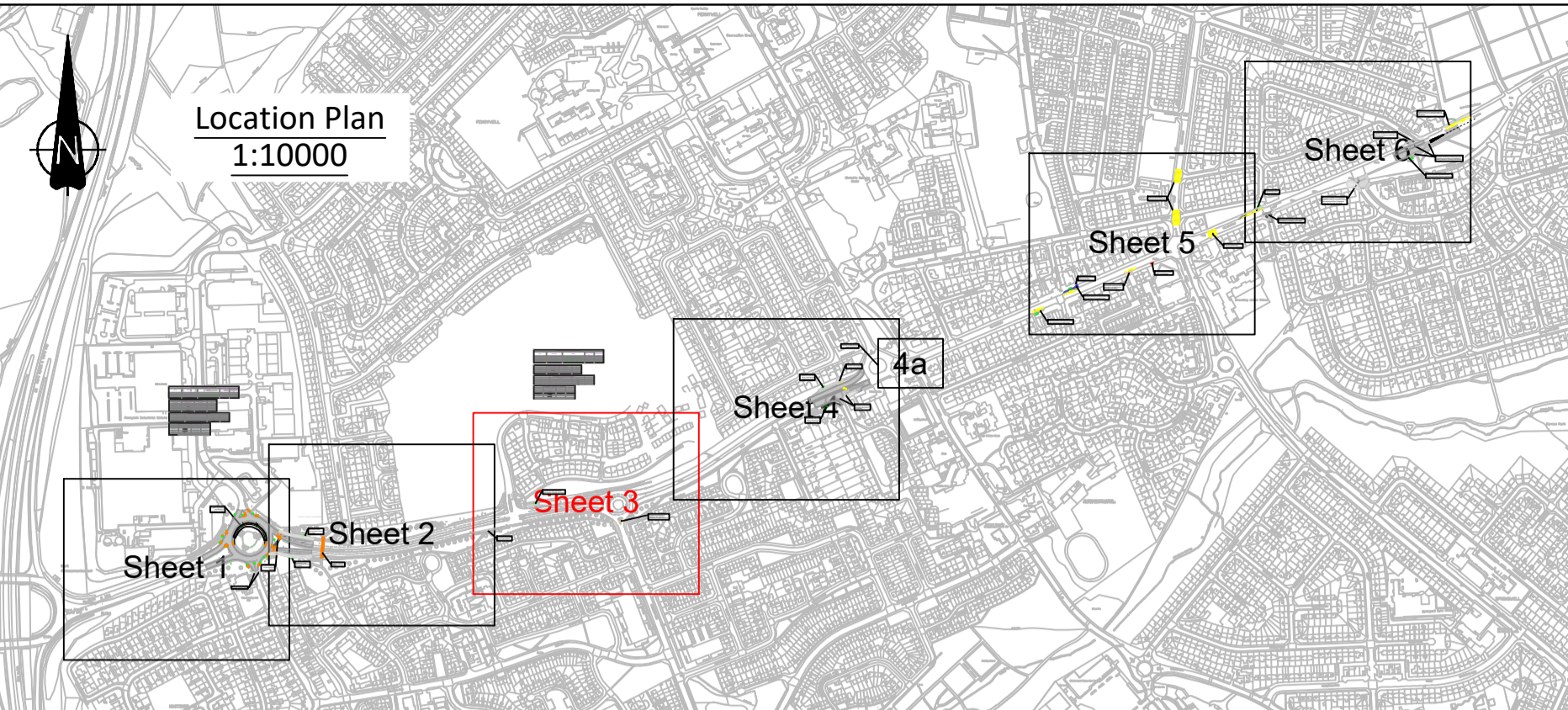

- Key:**
- Carriageway surfacing
  - Footway surfacing
  - Bus stop treatment
  - Layby improvements
  - Tactile Paving

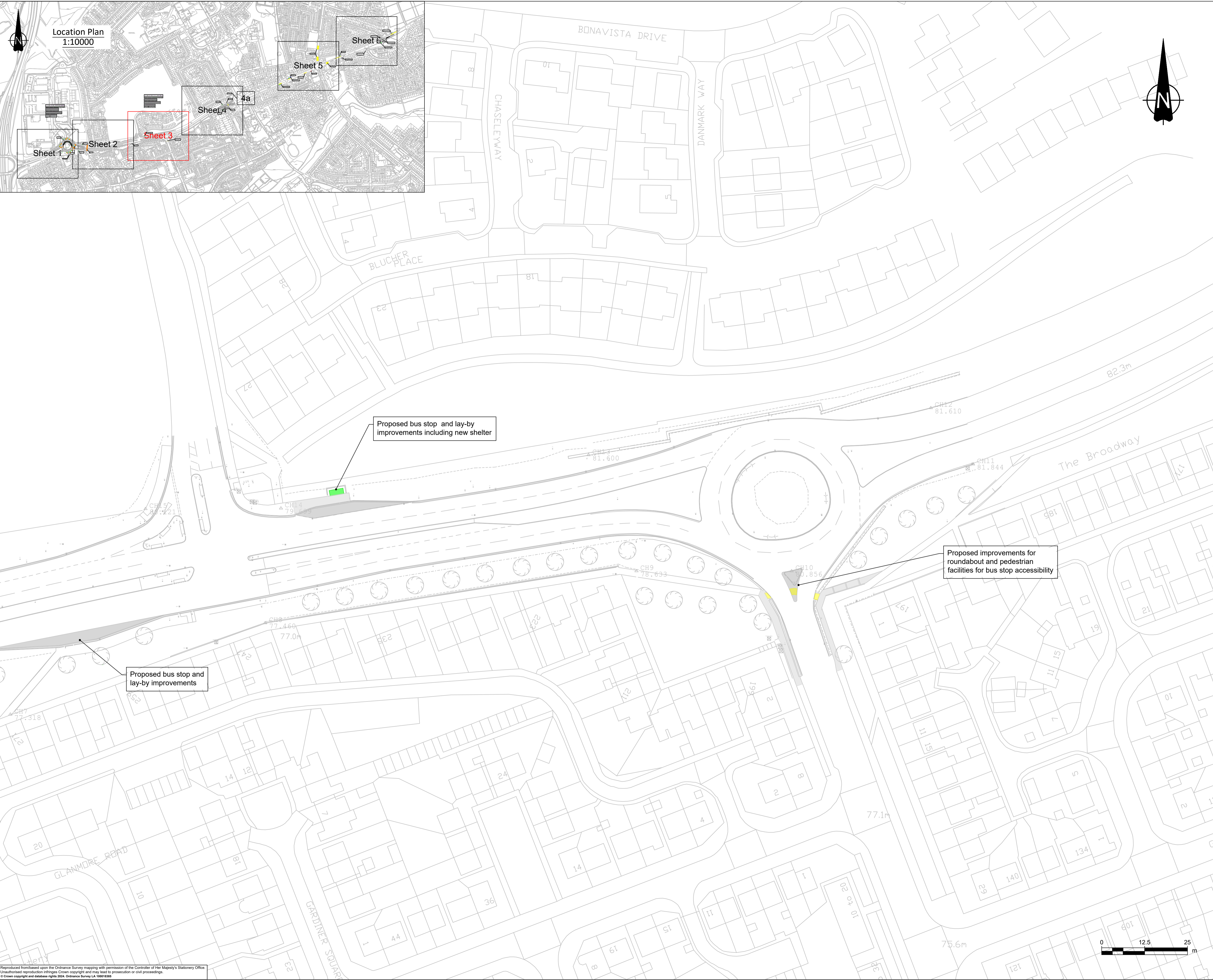

Proposed bus stop and lay-by improvements including new shelter

Proposed improvements for roundabout and pedestrian facilities for bus stop accessibility

Proposed bus stop and lay-by improvements

**FOR DISCUSSION**

P02	25.08.28	Addition of pedestrian crossing improvements, roundabout white lining and the removal of traffic signals	JT	PK
Rev.	Date	Description	Drawn	Approved

**Sunderland City Council**

City Development Directorate  
 City Hall,  
 Plater Way,  
 Sunderland,  
 SR1 3AA

Project  
**Bus Service Improvement Plan (BSIP) Chester Road**

Subject  
**Improvements (LTN124) Sheet 3 of 6**

Contact Peter Kennedy Approved by PK  
 Drawn by JS Sheet size A1  
 Scale 1:500 Date 13/06/2025

Drawing No. BSIPCR-SCC-HGN-00-DR-CR-01\_103 Revisions P01

Reproduced from based upon the Ordnance Survey mapping with permission of the Controller of Her Majesty's Stationery Office. Unauthorised reproduction infringes Crown copyright and may lead to prosecution or civil proceedings. © Crown copyright and database rights 2024. Ordnance Survey Ltd. 100043861



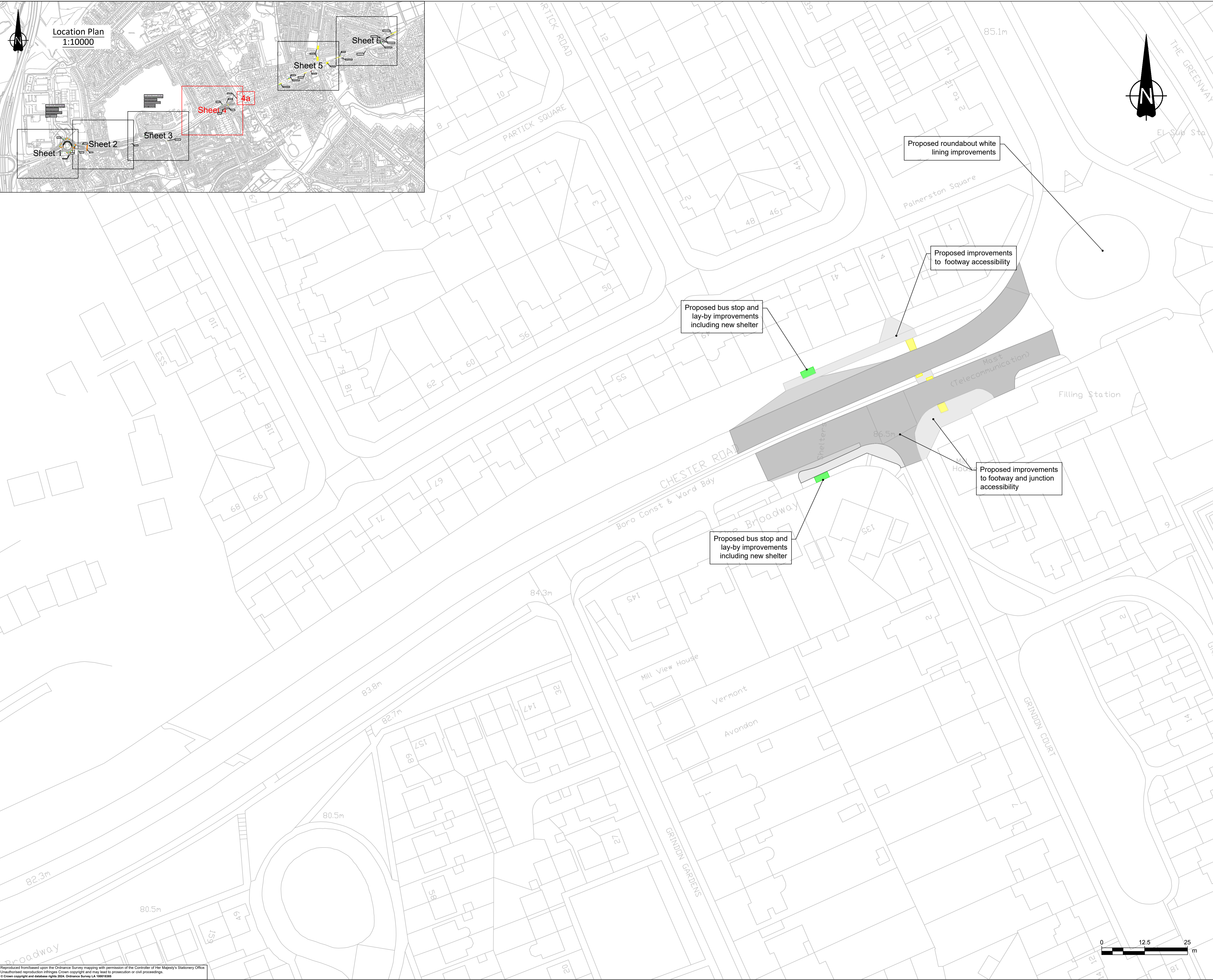
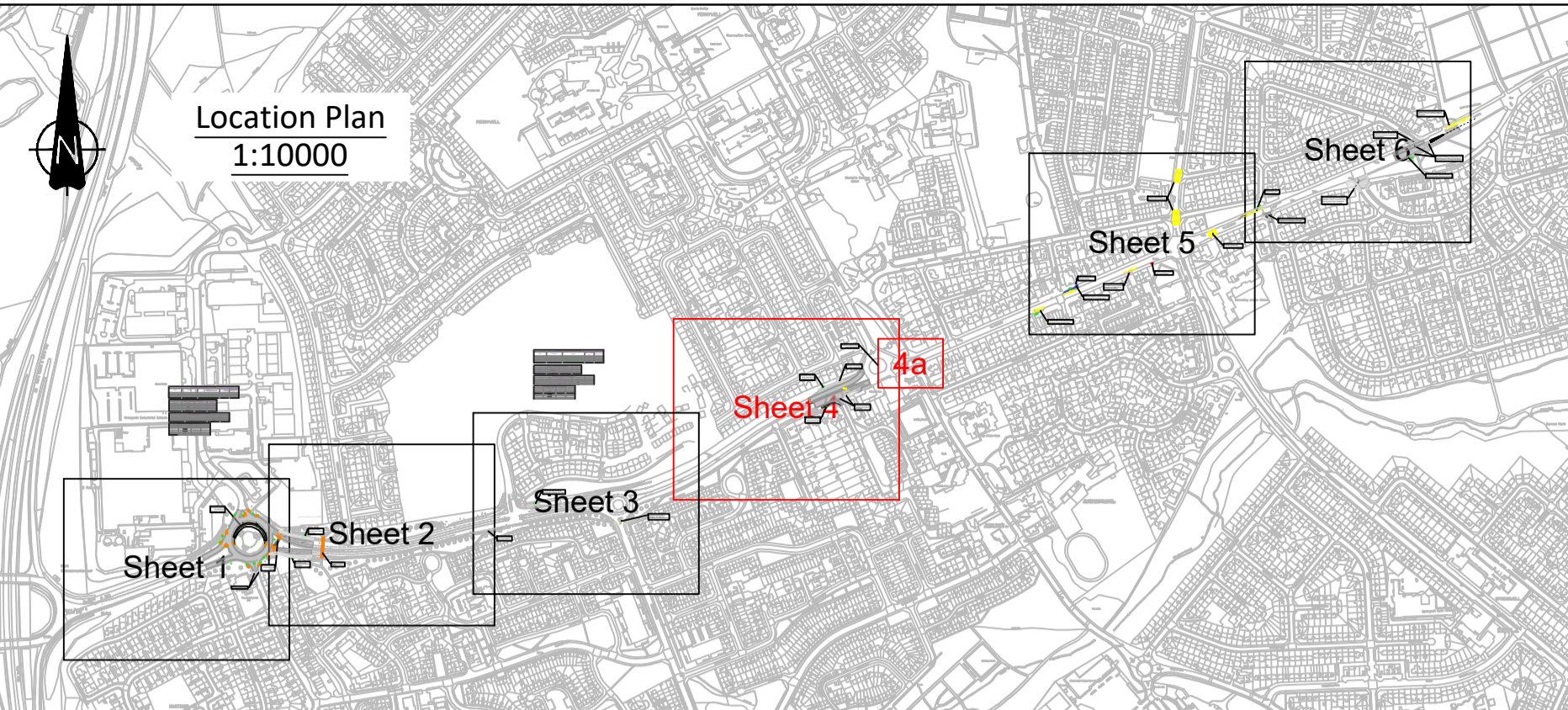

- Key:**
- Carriageway surfacing
  - Footway surfacing
  - Bus stop treatment
  - Layby improvements
  - Tactile Paving

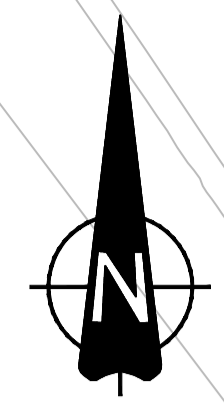

**FOR DISCUSSION**

Rev	Date	Description	Drawn	Approved
P02	25.08.28	Addition of pedestrian crossing improvements, roundabout white lining and extent of improved surfacing	JT	PK

**Sunderland City Council**

City Development Directorate  
 City Hall,  
 Plater Way,  
 Sunderland,  
 SR1 3AA

Project  
**Bus Service Improvement Plan (BSIP) Chester Road**

Subject  
**Improvements (LTN124) Sheet 4 of 6**

Contact Peter Kennedy Approved by PK  
 Drawn by JS Sheet size A1  
 Scale 1:500 Date 13/06/2025

Drawing No. BSIPCR-SCC-HGN-00-DR-CR\_01\_104 Revisions P02

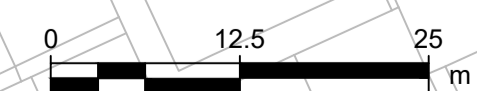

Reproduced from based upon the Ordnance Survey mapping with permission of the Controller of Her Majesty's Stationery Office. Unauthorised reproduction infringes Crown copyright and may lead to prosecution or civil proceedings. © Crown copyright and database rights 2024. Ordnance Survey Ltd. 10004388

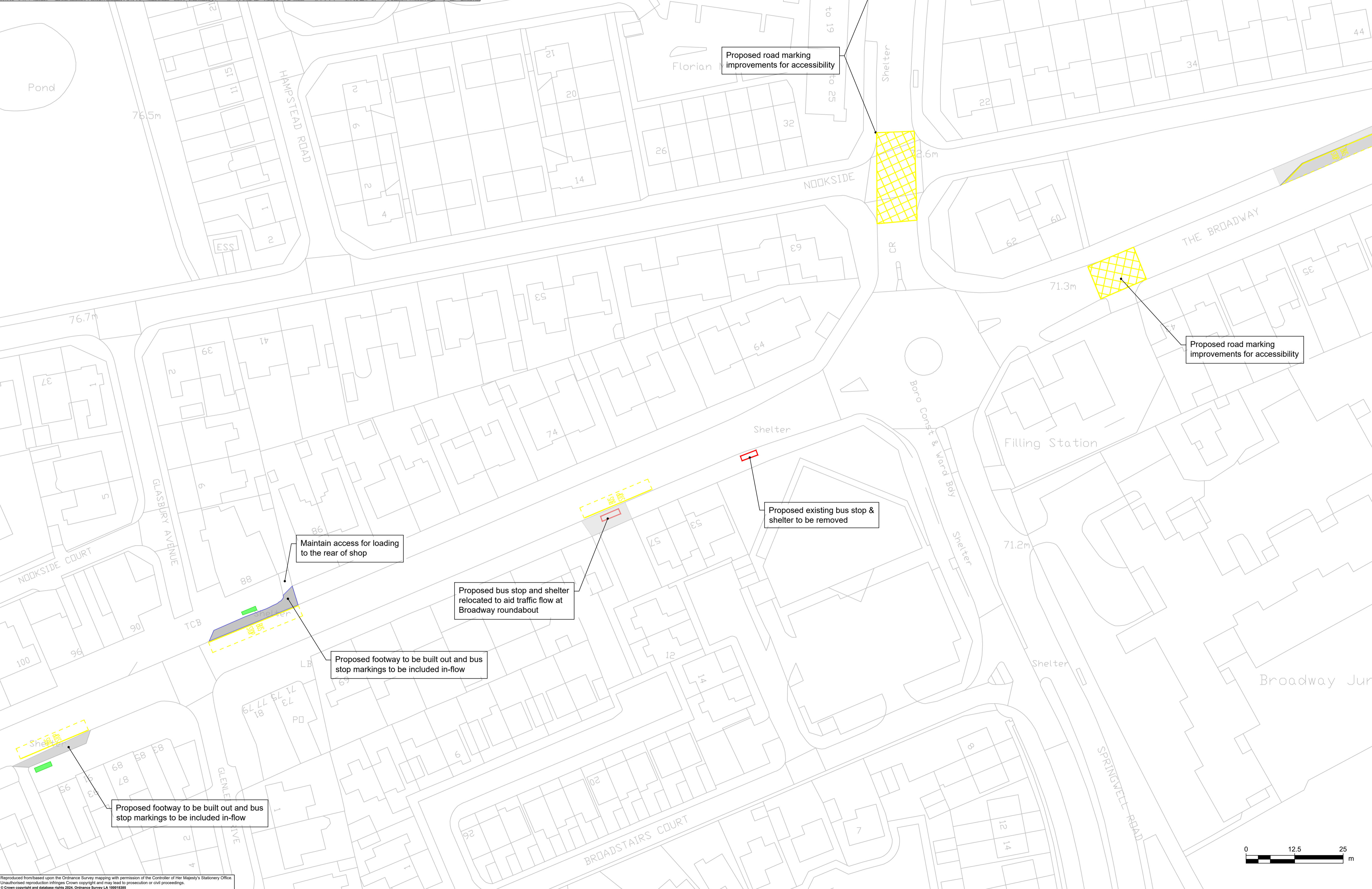
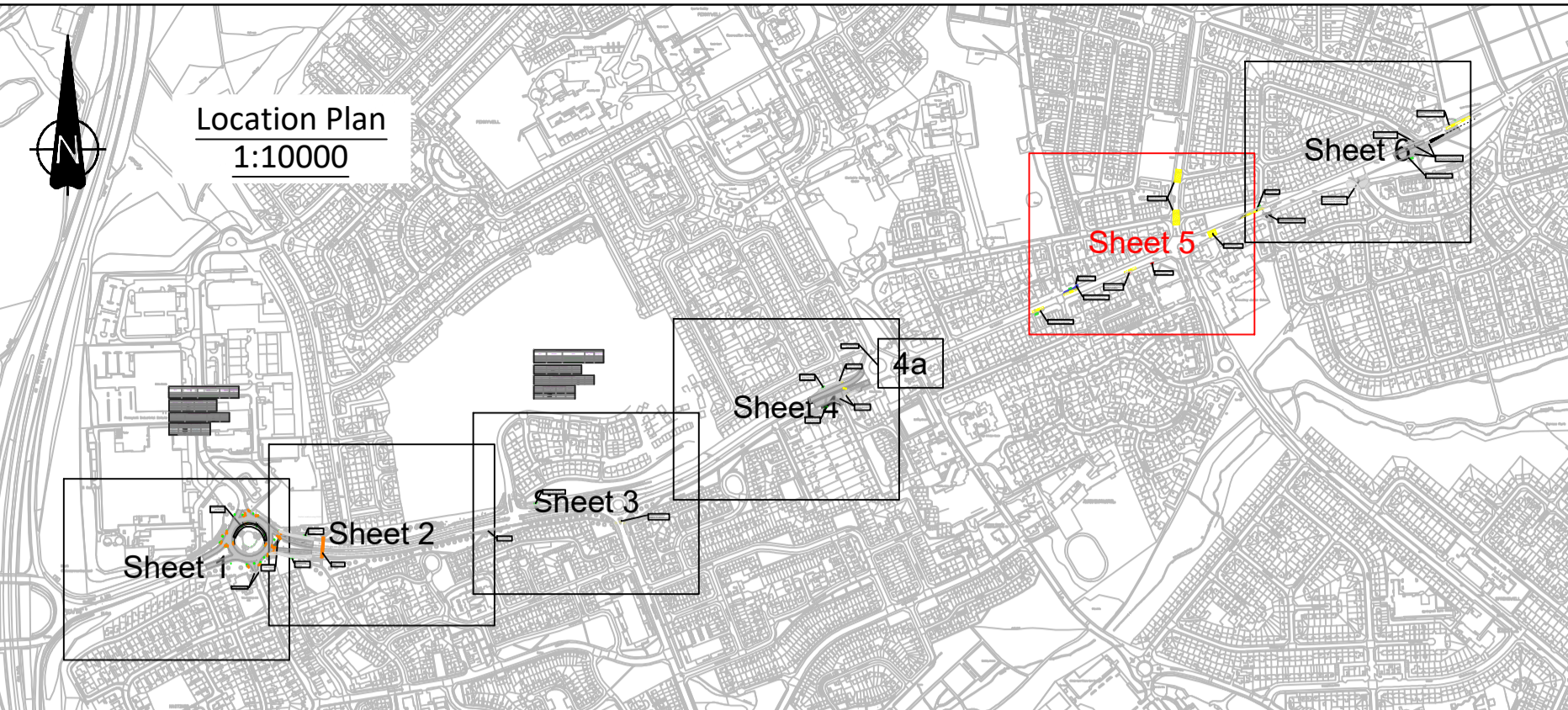

- Key:**
- Carriageway surfacing
  - Footway surfacing
  - Bus stop treatment
  - Layby improvements
  - Tactile Paving

**FOR DISCUSSION**

PO2	25.08.28	Addition of pedestrian crossing improvements, box junctions and 1x bus stop & shelter relocation	JT	PK
Rev.	Date	Description	Drawn	Approved

**Sunderland City Council**

City Development Directorate  
 City Hall,  
 Plater Way,  
 Sunderland,  
 SR1 3AA

Project  
**Bus Service Improvement Plan (BSIP) Chester Road**

Subject  
**Improvements (LTN124) Sheet 5 of 6**

Contact	Peter Kennedy	Approved by	PK
Drawn by	JS	Sheet size	A1
Scale	1:500	Date	13/06/2025
Drawing No.	BSIPCR-SCC-HGN-00-DR-CR-01_105	Revisions	P02

Reproduced from/based upon the Ordnance Survey mapping with permission of the Controller of Her Majesty's Stationery Office. Unauthorised reproduction infringes Crown copyright and may lead to prosecution or civil proceedings. © Crown copyright and database right 2024. Ordnance Survey 1:100000000

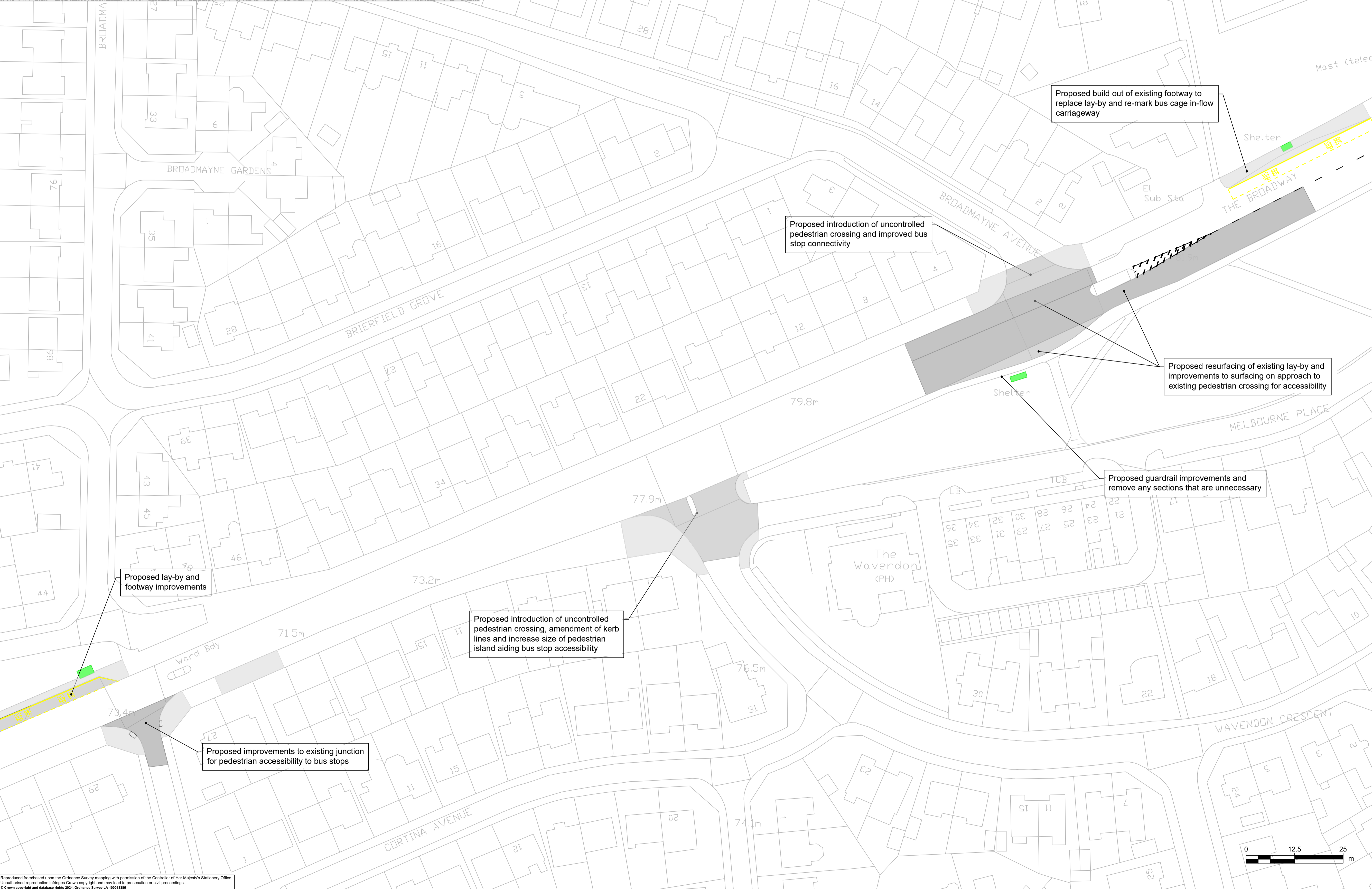
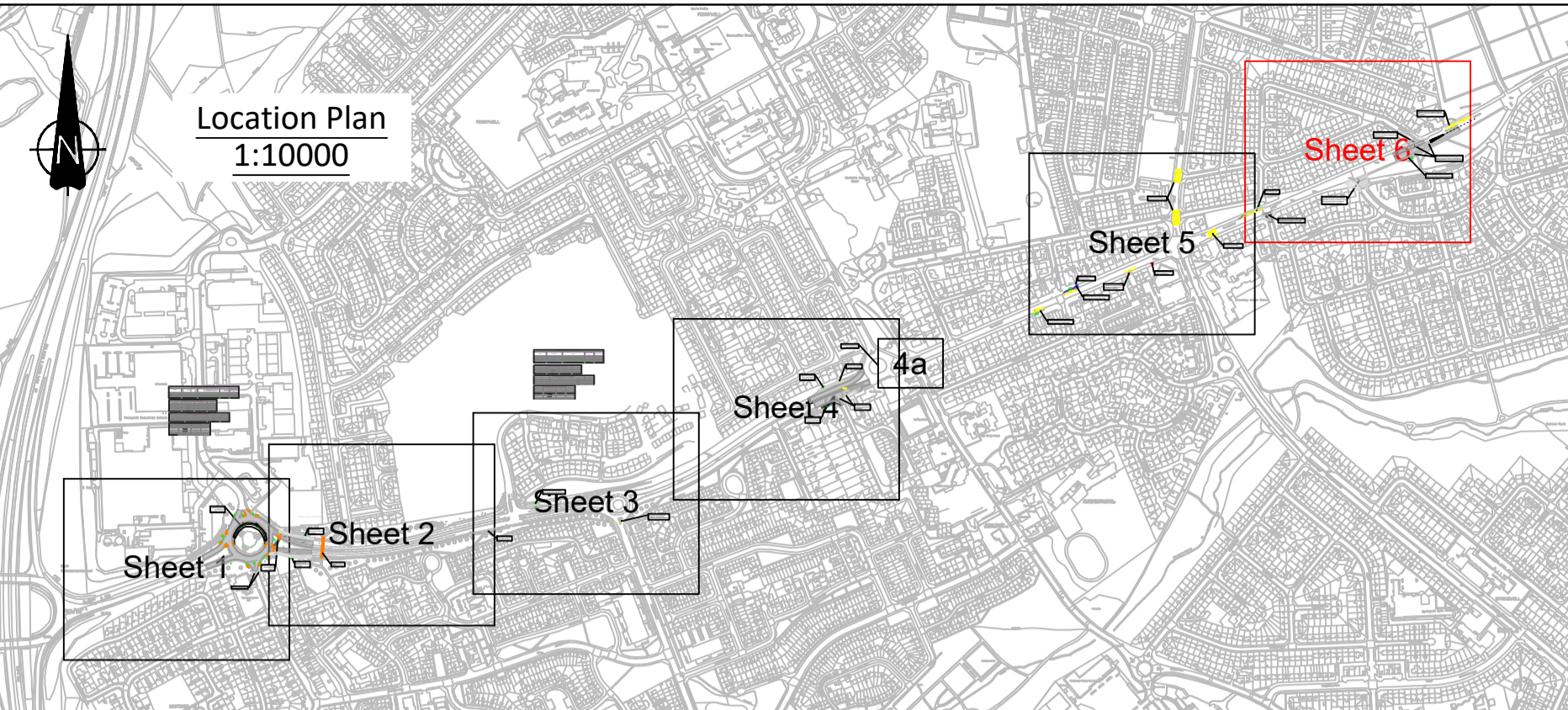

- Key:**
- Carriageway surfacing
  - Footway surfacing
  - Bus stop treatment
  - Layby improvements
  - Tactile Paving

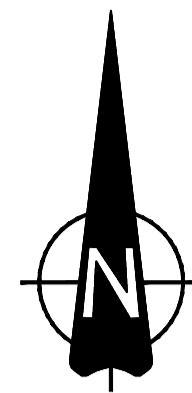

**FOR DISCUSSION**

Rev	Date	Description	Drawn	Approved
P02	25.08.28	Addition of pedestrian crossing improvements & extent of surface improvements	JT	PK

**Sunderland City Council**

City Development Directorate  
 City Hall,  
 Plater Way,  
 Sunderland,  
 SR1 3AA

Project  
**Bus Service Improvement Plan (BSIP) Chester Road**

Subject  
**Improvements (LTN124) Sheet 6 of 6**

Contact Peter Kennedy Approved by PK  
 Drawn by JS Sheet size A1  
 Scale 1:500 Date 13/06/2025

Drawing No. BSIPCR-SCC-HGN-00-DR-CR-01\_106 Revisions P02

Reproduced from based upon the Ordnance Survey mapping with permission of the Controller of Her Majesty's Stationery Office. Unauthorised reproduction infringes Crown copyright and may lead to prosecution or civil proceedings. © Crown copyright and database rights 2024. Ordnance Survey Ltd. 100016388

