

Patrons:  
Dame Sylvia Crowe, D.B.E.; The Right Honourable Lord Denning;  
Dame Elisabeth Frink, D.B.E., R.A.; P. F. Garthwaite Esq., O.B.E.;  
Sir Charles Groves, C.B.E.; R. Hammond Innes, C.B.E.;  
Professor W. G. Hoskins, C.B.E.; The Earl of Lichfield;  
Miss Moura Lympny, C.B.E.; E. M. Nicholson Esq., C.B., C.V.O.

Council of Management:  
K. Watkins, O.B.E. (Chairman); O. G. Rossetti, M.A.; S. Edgecombe, J.P., F.C.A.;  
C. P. Wright, M.Sc., A.R.I.C.S., A.L.I.; R. H. Trafford, M.A.;  
D. G. Waddams, F.C.C.A.; T. H. White, F.R.I.C.S., F.A.A.V.;  
T. W. Wright, B.Sc. (For.), Ph.D.; D. H. Marks, M.I.P.A.

the  
woodland  
trust



Executive Director: John D. James

DIRECTOR OF ENGINEERING SUNDERLAND RECEIVED - 4 SEP 1990	
REF. NO. 8	FILE NO. CB

If no telephone response at the number below  
please ring (0476) 74297

Please reply to:

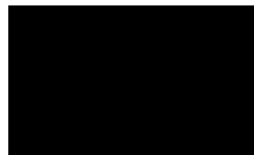

Our Ref: EAS/MI  
31 August 1990

Director of Engineering  
Town Hall and Civic Centre  
PO Box 103  
Sunderland  
SR2 7DN

Dear Sir,

HIGHWAYS ACT 1980 - Section 31(6)

WOODLAND AT WASHINGTON, TYNE AND WEAR

I enclose a notice as required by the above Act **declaring** those ways known to be public highways on the above properties. It is the Trust's aim to confirm its intention not to dedicate any further highways over its properties by depositing a Statutory Declaration to this effect within six years from today and to repeat this process thereafter.

I would welcome any comments which you may wish to make on this letter or its enclosures.

Please acknowledge receipt of the formal notice.

Yours faithfully

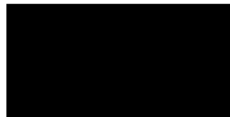

Liz Strange  
Woodland Operations

Patrons:  
Dame Sylvia Crowe, D.B.E.; The Right Honourable Lord Denning;  
Dame Elisabeth Frink, D.B.E., R.A.; P. F. Ganhwaite Esq., O.B.E.;  
Sir Charles Groves, C.B.E.; R. Hammond Innes, C.B.E.;  
Professor W. G. Hoskins, C.B.E.; The Earl of Lichfield;  
Miss Moura Lypany, C.B.E.; E. M. Nicholson Esq., C.B., C.V.O.

Council of Management:  
K. Watkins, O.B.E. (Chairman); O. G. Rossetti, M.A.; S. Edgcumbe, J.P., F.C.A.;  
C. P. Wright, M.Sc., A.R.I.C.S., A.L.I.; R. H. Trafford, M.A.;  
D. G. Waddams, F.C.C.A.; T. H. White, F.R.I.C.S., F.A.A.V.;  
T. W. Wright, B.Sc. (For.), Ph.D.; D. H. Marks, M.I.P.A.



Executive Director: John D. James

DIRECTOR OF ENGINEERING  
SUNDERLAND  
RECEIVED  
- 4 SEP 1990

REF. No.	FILE No.
8	C12/W

cb

If no telephone response at the number below  
please ring (0476) 74297

Please reply to:

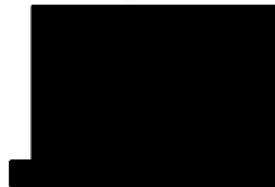

Our Ref: EAS/MI  
31 August 1990

Director of Engineering  
Town Hall and Civic Centre  
PO Box 103  
Sunderland  
SR2 7DN

Dear Sir,

HIGHWAYS ACT 1980 - Section 31(6)

WOODLAND AT MOUNT PLEASANT, WASHINGTON, TYNE AND WEAR

The Woodland Trust, a company limited by guarantee and registered charity no. 294344, of Autumn Park, Dysart Road, Grantham, Lincolnshire, freehold owners of the property known as two plots of Woodland (3.92 acres) at Mount Pleasant which are shown outlined in red on the attached plans, hereby gives notice in accordance with Section 31 (6) of the Highways Act 1980 that there are no ways over the land shown on the attached plans as being owned by the Woodland Trust which have been dedicated as public highways.

Yours faithfully



Liz Strange  
Woodland Operations, authorised to sign on behalf of the  
Woodland Trust.

STO

See VF + then me  
Pew

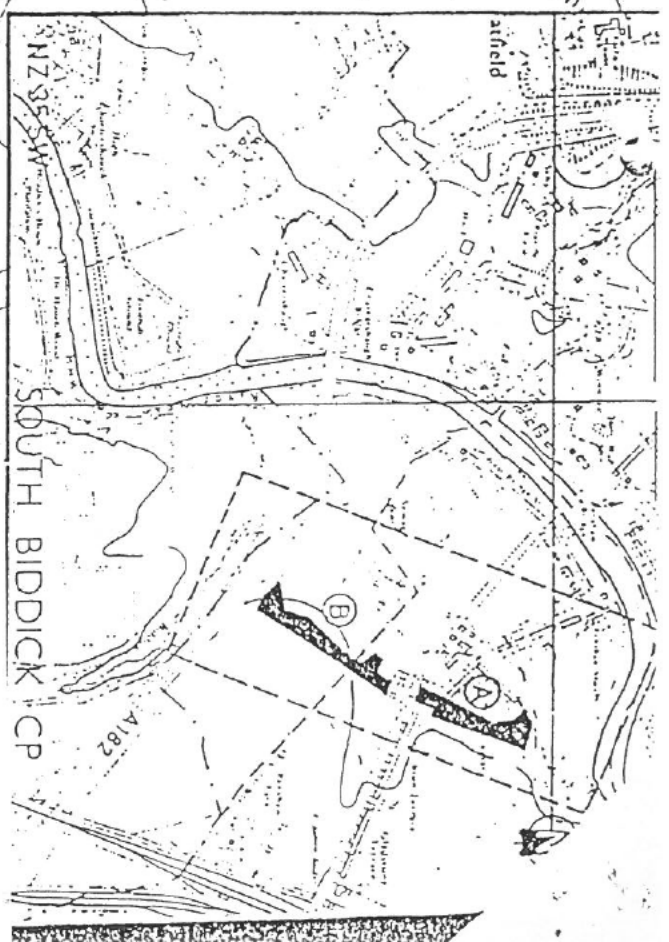
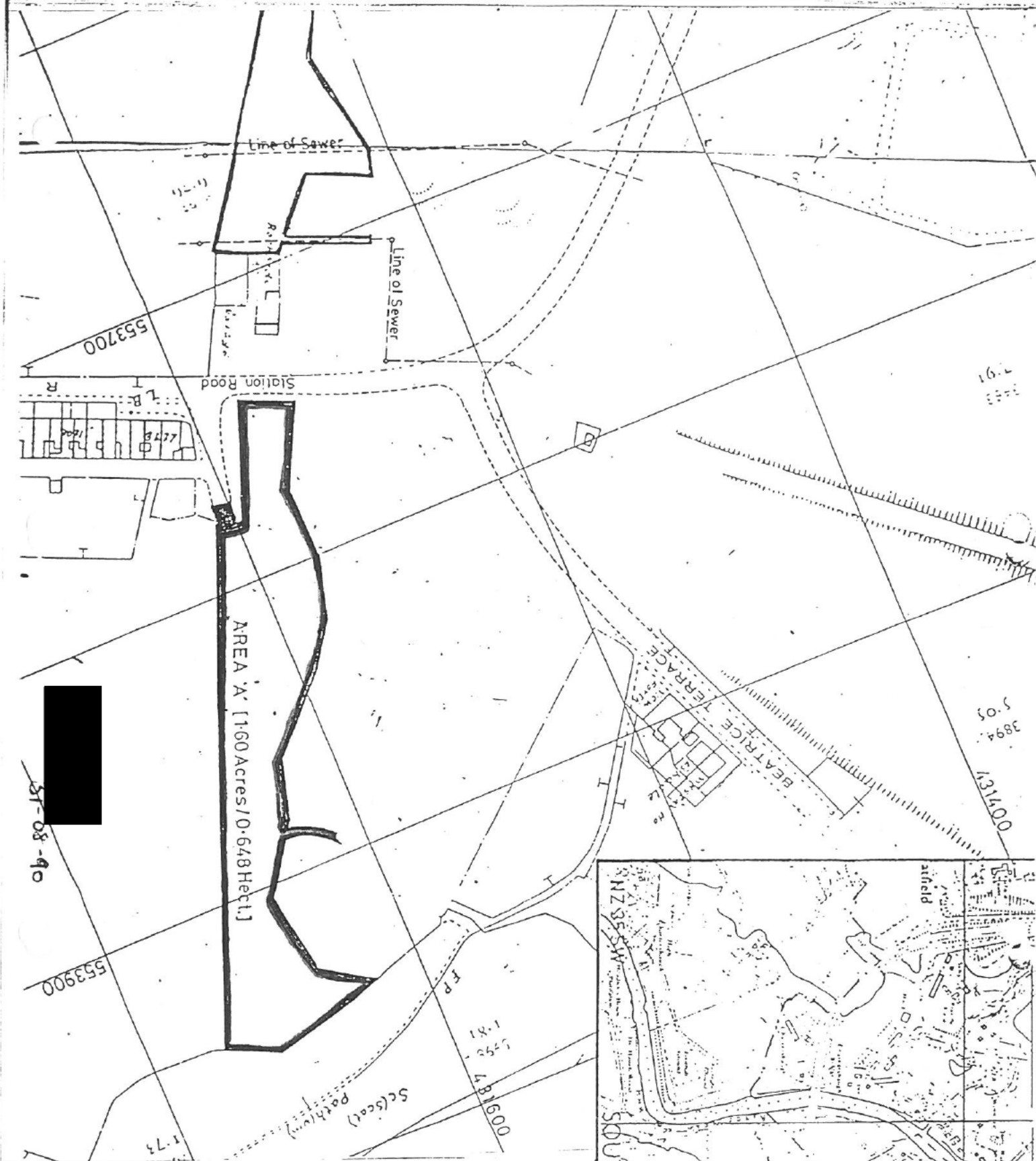

Reproduced from the Ordnance Survey's  
 1:1250 (scale) map of  
 permission of the Controller of  
 Her Majesty's Stationery Office,  
 Crown copyright reserved.  
 The Woodland Trust Date 30/03/90  
 Autumn Park, Grantham, Lincs NG31 6LL

ST-08-90

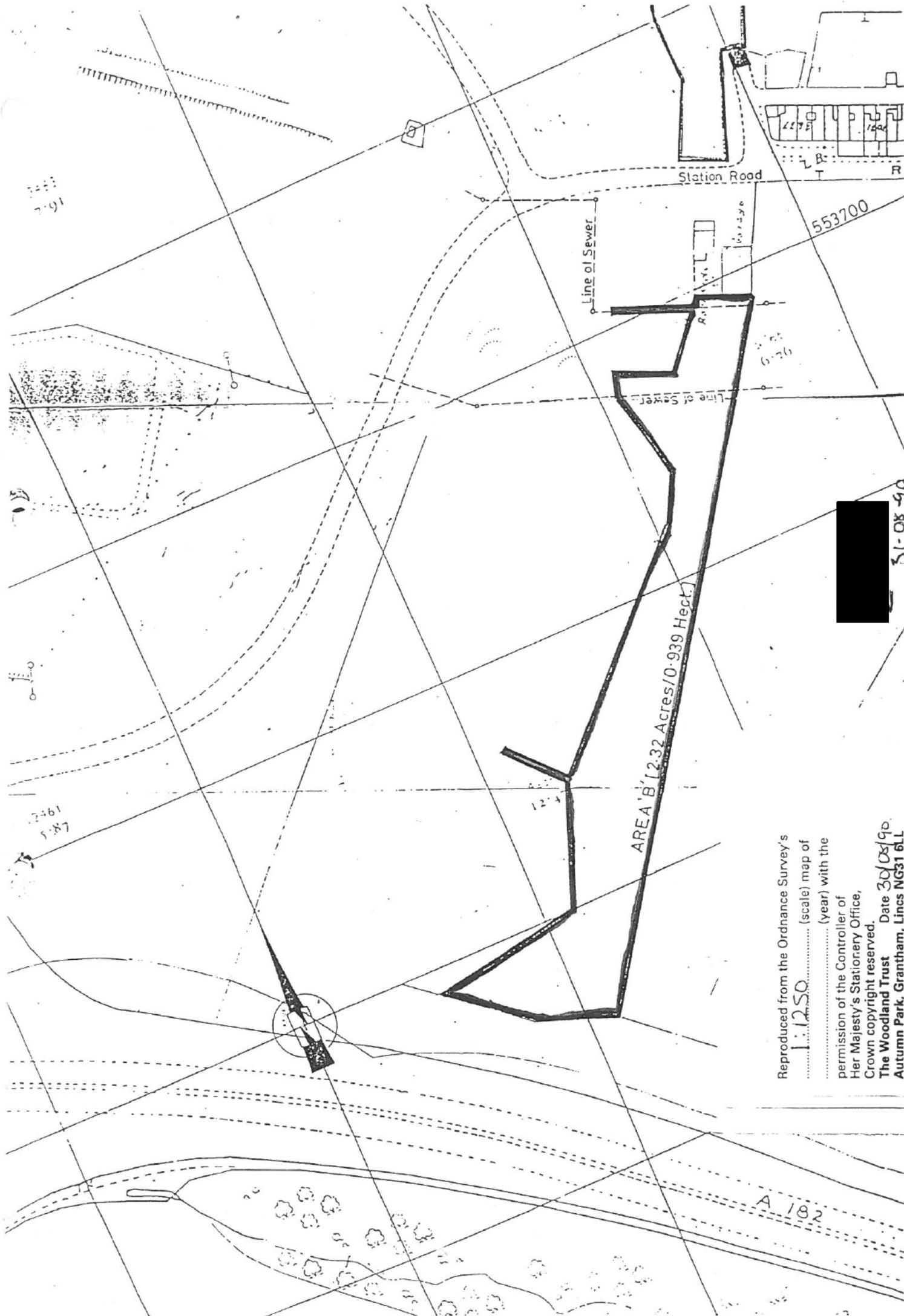

AREA 'B' [2.32 Acres / 0.939 Hect.]

Station Road

Line of Sewer

Line of Sewer

A 182

Reproduced from the Ordnance Survey's  
 1:1250 ..... (scale) map of  
 ..... (year) with the  
 permission of the Controller of  
 Her Majesty's Stationery Office,  
 Crown copyright reserved.  
 The Woodland Trust Date 30/08/90  
 Autumn Park, Grantham, Lincs NG31 6LL



SI-08-90